

SALES DRAWING

SALES DRAWING

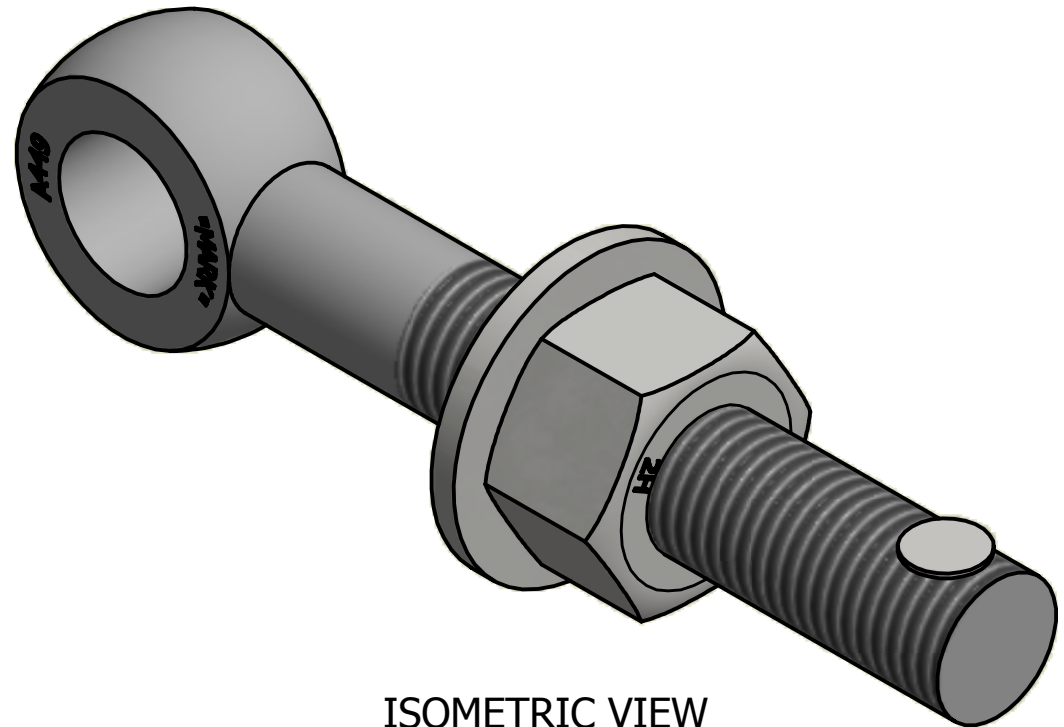
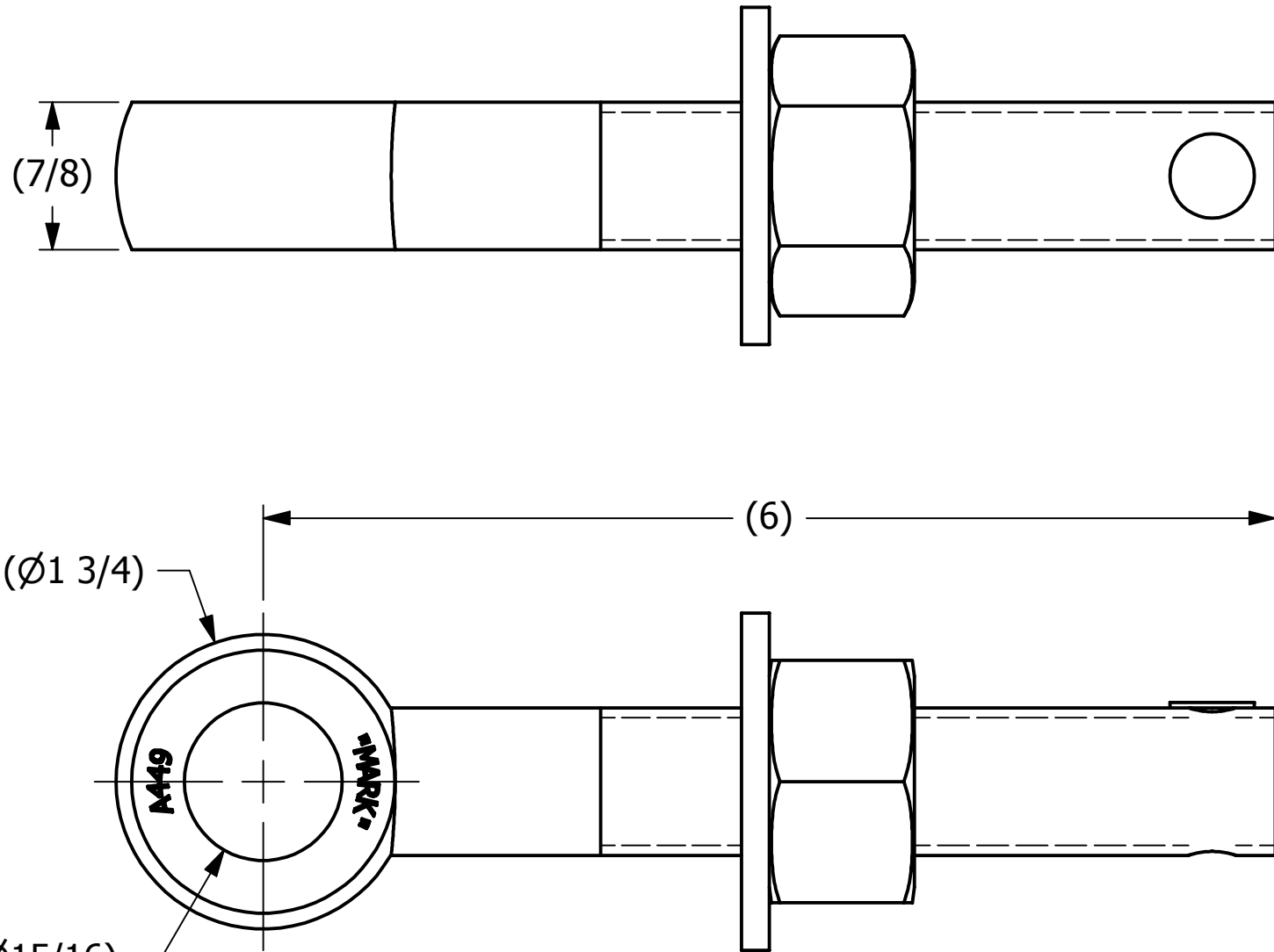

ISOMETRIC VIEW

NOTE:
JET LUBE(PFPE GREASE) APPLIED TO WORKING THREAD AREA,
THE BOTTOM FACE OF THE NUT, AND THE TOP FACE OF THE
WASHER.

THIS PRINT, PROPERTY OF SALCO PRODUCTS INC., CONTAINS PROPRIETARY INFORMATION
AND MUST NOT BE COPIED, REPRODUCED, OR USED DETRIMENTALLY TO OUR INTEREST.

UNLESS OTHERWISE SPECIFIED DIMENSIONAL TOLERANCES FRACTIONAL: $\pm 1/16$ X.XX: $\pm .03$ X.XXX: $\pm .015$ ANGULAR: $\pm 1^\circ$ DEBURR ALL SHARP EDGES. ALL MACHINED SURFACES TO HAVE A 125 RMS FINISH UNLESS NOTED OTHERWISE. THIRD ANGLE PROJECTION		DRAWN BY:	RJP	<div><div></div><div>SALCO PRODUCTS, INC.</div></div>		
		CHECKED BY:	ACC			
		PROTOTYPE BY:	RJP	PART NAME: EYEBOLT ASSEMBLY 7/8"X6"		
		PROTOTYPE DATE:	2/1/2007	MATERIAL: CARBON STEEL, ASTM A449 TYPE 1		
<div><div></div><div></div></div>		APPROVED FOR PRODUCTION BY:	ACC	PROJECT #: WAG0395	SHEET #: 1 OF 1	SCALE: 1:1
		PRODUCTION DATE:	4/13/2007	DRAWING #: B23097	PART #: EB786XAG5L	